

# DigiCam Surveillance

## CC600 1/4" D.S.P. Color CCD High Speed 480 TV Lines Pan/Tilt/Zoom Camera

For a high resolution indoor PTZ dome, it doesn't get much better than 480 lines of resolution, 360 degree rotation, 180 degrees horizontal rotation with instant flip and 18X optical zoom. This PTZ dome is a perfect match with a compatible DVR such as our Cinturon series or it can be controlled by the CK101 or CK102.

### FEATURES

- For use with 1/4 inch format camera with 480TV lines horizontal resolution
- Electronic shutter control
- 360 degree continuous rotation
- Optical zoom of 18X for HS-CC600A, 18X for HS-CC610, 25X for HS-CC620
- 64 preset positions
- Horizontal rotation of 180 degree (instant flip)
- Auto iris & focus
- RS-485 interface & telemetry control

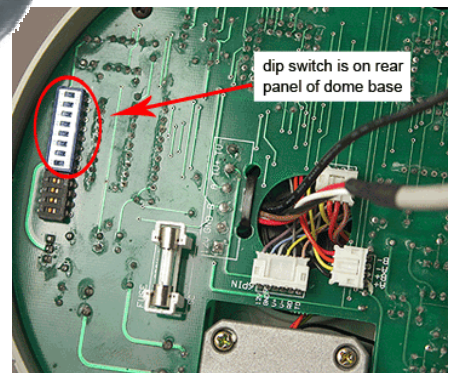

This camera uses the **B17** or **B19** bracket. Click on the picture to the right for more info or to order.



B17



B19

## SPECIFICATIONS

<b>Image Sensor</b>	1/4 type Super HAD CCD
<b>Resolution</b>	480 TV Lines
<b>Minimum Illumination</b>	1.0 lx (F1.4, normal shutter speed)
<b>Lens Furnished</b>	18X Zoom f=4.1 to 73.8mm (F1.4 to F3.0)
<b>Power Supply</b>	DC 12V
<b>Power Consumption</b>	1A
<b>Number of Effective Pixels</b>	NTSC: 768(H) x 494(V)PAL: 752(H) X 582(V)
<b>Digital Zoom</b>	12X (216X with optional zoom)
<b>Angle of View (H)</b>	Approx. 48 degree (wide end) Approx. 2.8 degree (tele end)
<b>Min. Object Distance</b>	10mm (wide end), 800mm (tele end)
<b>Sync. System</b>	Internal /External (V-Lock)
<b>S/N Ratio</b>	More than 50dB
<b>Electronic Shutter</b>	1/60(1/50) to 1/10000sec. 16 steps
<b>White Balance</b>	Auto, ATW, Indoor, Outdoor One Push WB, Manual
<b>Gain</b>	Auto / Manual (-3 to 28dB, 16 x 2dB step)
<b>AE Control</b>	Auto, Manual, Priority mode, bright, EV compensation, Black light compensation.
<b>EV compensation</b>	-10.5 to +10.5dB (1.5dB step)
<b>Back Light Compensation</b>	ON/OFF
<b>Focusing System</b>	Auto (Sensitivity: H,L), on-Push AF, Interval AF
<b>Camera Operation Switch</b>	Zoom Tele, Zoom wide
<b>Picture Effect</b>	Neg. art, Black & White
<b>Video Output</b>	VBS: 1.0Vp-p (Sync Negative)
<b>Camera Control Interface</b>	VISCA (TTL signal level)
<b>Shutter Control</b>	1/60-1/100,000 sec.
<b>Pan Travel</b>	360° continuous
<b>Tilt Travel</b>	0° ~ 90°
<b>Pan/Tilt Accuracy</b>	± 0.3°
<b>Manual Pan/Tilt Speed</b>	0.3° ~ 120°/sec
<b>Preset Positions</b>	.64 positions
<b>Instant Flip</b>	180°
<b>Preset Recall Speed</b>	150°/sec
<b>Address Setting</b>	1 ~ 32
<b>Control Interface</b>	RS-485
<b>Cable Requirement</b>	UL 24AWGx2C Twist Pair (recommend)
<b>Operating Temperature</b>	-20 to +50
<b>Operating Humidity</b>	0% ~ 90%
<b>Protocol</b>	Pelco P ONLY

**YOU MIGHT WANT TO PURCHASE A SEPARATE [CONTROLLER](#) FOR THIS CAMERA TO FACILITATE THE CONTROL**